



LANCASTER SQUARE

SOUTH RUISLIP

An exciting collection of 1, 2 & 3 bedroom apartments

Taylor
Wimpey

Contents

03



WELCOME TO
LANCASTER SQUARE



04



URBAN LIVING WITH
A DIFFERENCE

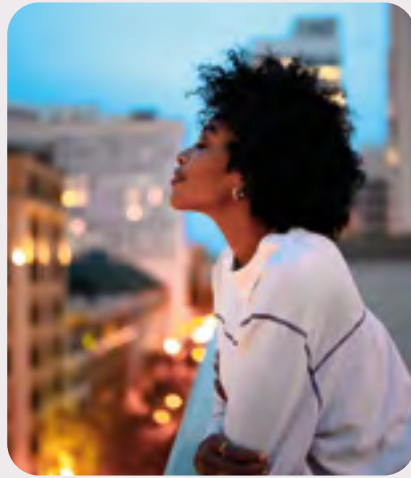

06



WELL-CONNECTED
WEST LONDON



12



DEVELOPMENT LAYOUT



13



OUR HOMES



43



WAYS TO MOVE



Welcome to Lancaster Square

A COLLECTION OF CONTEMPORARY 1, 2 & 3 BEDROOM APARTMENTS

Discover beautifully styled and superbly located apartment living at Lancaster Square. Our apartments are perfectly suited to first time buyers, young professionals and commuters. Make the most of modern living in a buzzing and friendly community.



Urban living with a difference

Being a west London location with easy access to acres of wonderful green spaces, living at Lancaster Square offers a more relaxed style of London living.

Between the Common and the woods, the 60-acre Ruislip Lido is the place to sit at the lakeside beach and cool down on hot days, take a walk, or stop for a picnic by the miniature railway.

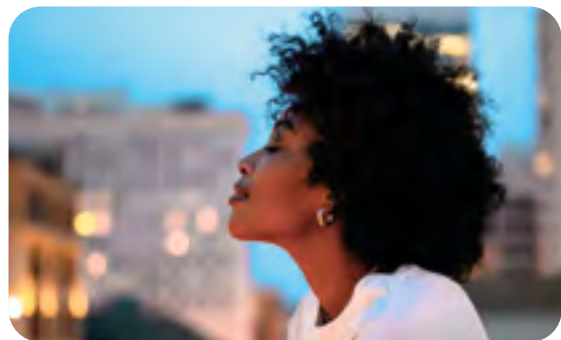

The local area has a proud heritage, with nearby Northolt airfield being one of the iconic airbases that played a key role during the Battle of Britain in 1940; with RAF and Polish Air Force squadrons flying Hurricanes and Spitfires to defend the skies.



Seeing the colours of the seasons, joining a wildlife watch walk, or taking a run listening to Ruislip Woods' famous morning birdsong, there's a feeling of wellbeing that comes from being close to nature.





Well-connected west London

Being this well placed for travel connections
enhances life in every way.

- South Ruislip station just a 2-minute walk from home.
- Rail and underground services direct into London Marylebone in 21 minutes.
- Oxford Circus is just 35 minutes away on the Central line and Bank in the heart of the City is 42 minutes.
- Days out in the capital for the shopping, the parks, or the South Bank riverside are easy.
- Excellent road connections with the A40/M40 conveniently close.
- M25 interchange only 6 miles away, making Heathrow just 7 miles away.



With everything from shopping to gyms and more within walking distance, Lancaster Square has the sought-after amenities for modern London living.



A fantastic location with excellent connections

Of course, home life is only part of the story. You can enjoy superb connections to other parts of the country too.

TRAVELLING BY CAR

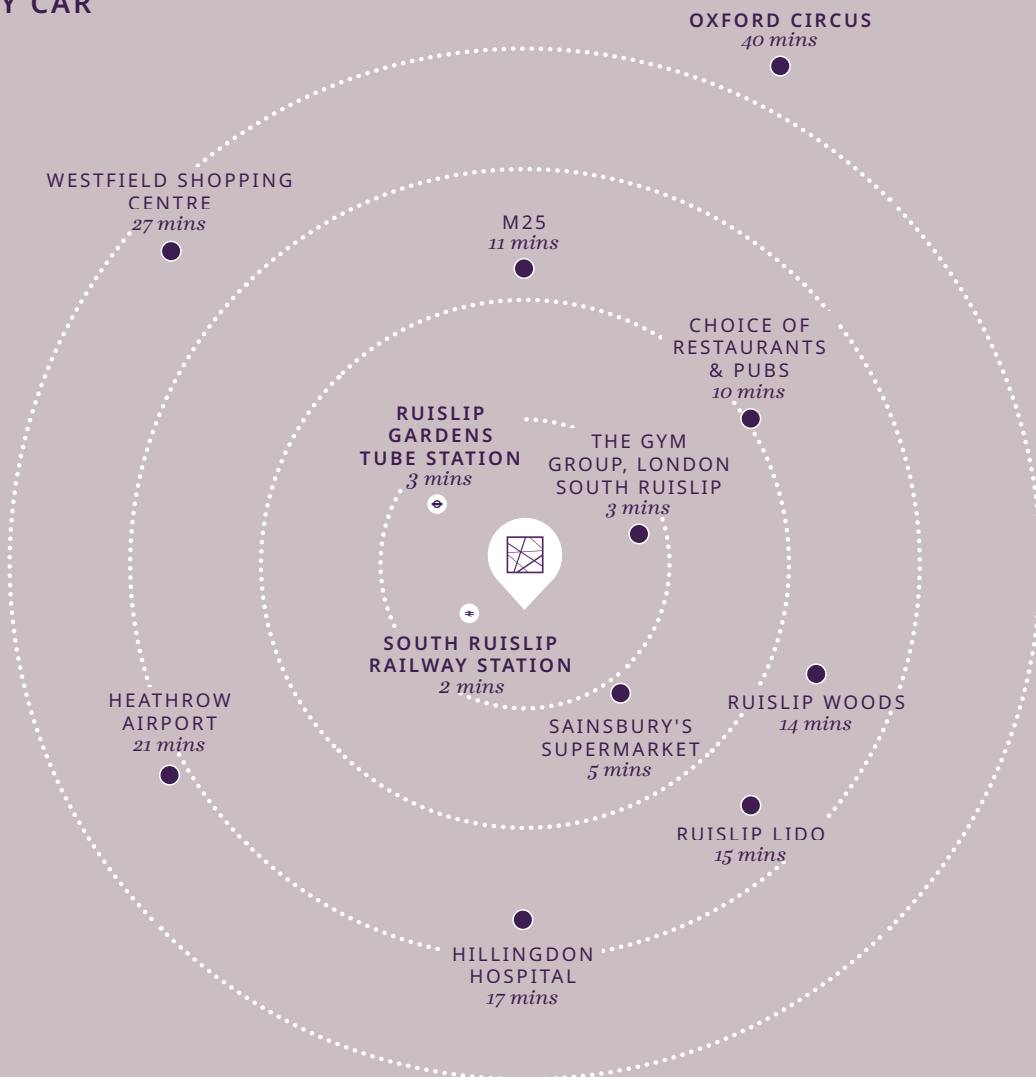



**Live life
to the full**



Beautifully
designed
homes perfect
for you



Our contemporary collection of homes have been thoughtfully designed for everyday living.

With bright, spacious rooms and stylish, flexible layouts you can be sure that you will feel at home straight away. You will truly feel that your new home has been designed with you in mind.



GET TO KNOW

Lancaster Square

SOUTH RUISLIP



The Development Layout does not show details of gradients of land, boundary treatments, local authority street lighting or landscaping. It is our intention to build in accordance with this layout. However, there may be occasions when the house designs, boundaries, landscaping and positions of roads and footpaths change as the development proceeds. Please check the details of your chosen property with your sales executive prior to reservation. Please speak to our sales executives regarding the tenure of our new homes.

**Taylor
Wimpey**

Vickers House



A STUNNING COLLECTION OF
1, 2 AND 3 BEDROOM APARTMENTS



Vickers House

Plot 55

3 BEDROOM HOME, 975 SQ.FT.



KITCHEN
4.48m x 1.87m
14'9" x 6'2"

LIVING/DINING AREA
5.69m x 3.76m
18'9" x 12'4"

BEDROOM 1
5.50m x 3.14m
18'1" x 10'4"

BEDROOM 2
4.48m x 2.83m
14'9" x 9'4"

BEDROOM 3
3.75m x 2.71m
12'4" x 8'11"

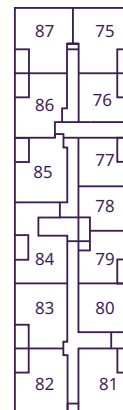

Second Floor

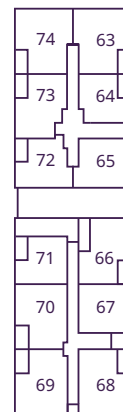

First Floor

Plot 56

1 BEDROOM HOME, 634 SQ.FT.



KITCHEN
3.52m x 2.53m
11'7" x 8'4"

LIVING/DINING AREA
5.03m x 3.52m
16'6" x 11'7"

BEDROOM 1
5.18m x 3.80m
17'0" x 12'6"

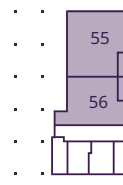

Ground Floor

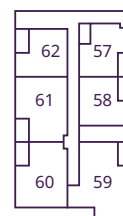

Vickers House

Plot 57

1 BEDROOM HOME, 540 SQ.FT.



**KITCHEN/LIVING/
DINING AREA**
5.81m x 3.76m
19'1" x 12'4"

BEDROOM 1
4.39m x 3.91m
14'5" x 12'0"

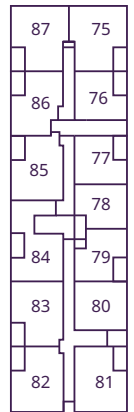

Second Floor

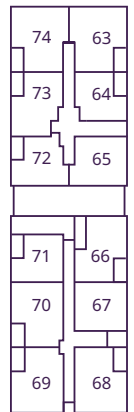

First Floor

Plot 58

1 BEDROOM HOME, 550 SQ.FT.



KITCHEN
3.75m x 1.89m
12'4" x 6'3"

LIVING/DINING AREA
3.94m x 3.82m
13'0" x 12'6"

BEDROOM 1
4.77m x 3.60m
15'8" x 11'10"



Ground Floor

Vickers House

Plot 59

3 BEDROOM HOME, 950 SQ.FT.



KITCHEN
4.30m x 3.08m
14'1" x 10'1"

LIVING/DINING AREA
5.81m x 3.80m
19'1" x 12'6"

BEDROOM 1
4.99m x 3.05m
16'5" x 10'0"

BEDROOM 2
4.56m x 2.88m
15'0" x 9'5"

BEDROOM 3
3.57m x 2.26m
11'9" x 7'5"

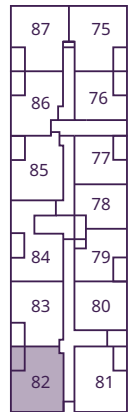

Second Floor

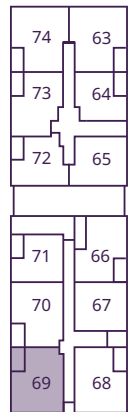

First Floor

Plots 60, 69 & 82

2 BEDROOM HOME, 767 SQ.FT.



KITCHEN
3.08m x 2.47m
10'1" x 8'2"

LIVING/DINING AREA
5.81m x 3.76m
19'1" x 12'4"

BEDROOM 1
4.88m x 3.08m
16'0" x 10'1"

BEDROOM 2
4.56m x 2.88m
15'0" x 9'6"



Ground Floor

Vickers House

Plot 61, 70 & 83

2 BEDROOM HOME, 770 SQ. FT.



KITCHEN

3.14m x 2.47m
10'4" x 8'2"

LIVING/DINING AREA

5.81m x 3.76m
19'1" x 12'4"

BEDROOM 1

4.88m x 3.14m
16'0" x 10'4"

BEDROOM 2

4.56m x 2.85m
15'0" x 9'5"

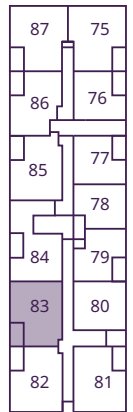

Second Floor

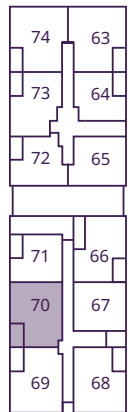

First Floor

Plot 62

1 BEDROOM HOME, 538 SQ.FT.



KITCHEN

3.69m x 1.89m
12'1" x 6'3"

LIVING/DINING AREA

3.81m x 3.81m
12'6" x 12'6"

BEDROOM 1

4.50m x 3.44m
14'10" x 11'4"

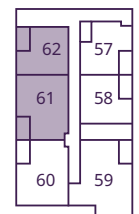
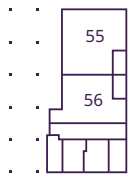

Ground Floor

Vickers House

Plots 63 & 75

2 BEDROOM HOME, 827 SQ.FT.



KITCHEN

3.29m x 3.14m
10'10" x 10'4"

LIVING/DINING AREA

5.81m x 3.76m
19'1" x 12'4"

BEDROOM 1

5.50m x 3.14m
18'1" x 10'4"

BEDROOM 2

4.38m x 2.83m
14'5" x 9'4"

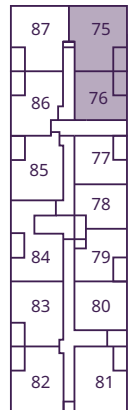

Second Floor

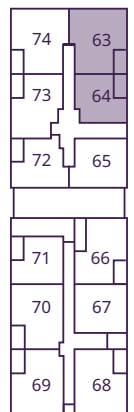

First Floor

Plots 64 & 76

1 BEDROOM HOME, 547 SQ.FT.



KITCHEN

3.71m x 1.89m
12'2" x 6'3"

LIVING/DINING AREA

3.90m x 3.82m
12'10" x 12'7"

BEDROOM 1

4.78m x 3.55m
15'8" x 11'8"

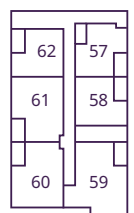

Ground Floor

Vickers House

Plot 65

1 BEDROOM HOME, 578 SQ.FT.



KITCHEN

2.98m x 2.48m
9'10" x 8'2"

LIVING/DINING AREA

4.65m x 4.12m
15'3" x 13'7"

BEDROOM 1

3.98m x 3.51m
13'1" x 11'6"

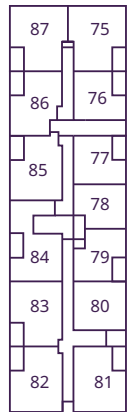

Second Floor

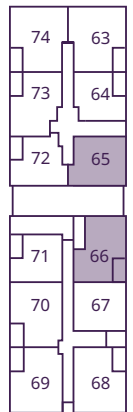

First Floor

Plot 66

2 BEDROOM HOME, 683 SQ.FT.



KITCHEN

3.49m x 1.87m
11'6" x 6'2"

LIVING/DINING AREA

4.37m x 3.84m
14'4" x 12'7"

BEDROOM 1

4.47m x 3.21m
14'8" x 10'7"

BEDROOM 2

4.47m x 2.99m
14'8" x 9'10"

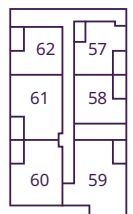
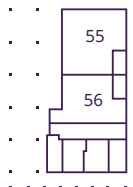

Ground Floor

Vickers House

Plots 67 & 80

1 BEDROOM HOME, 626 SQ.FT.



**KITCHEN/LIVING/
DINING AREA**
5.81m x 4.24m
19'1" x 13'11"

BEDROOM 1
4.83m x 3.60m
15'11" x 11'10"

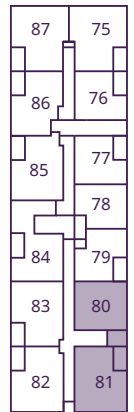

Second Floor

Plot 68 & 81

2 BEDROOM HOME, 776 SQ.FT.



KITCHEN
3.08m x 2.47m
10'1" x 8'2"

LIVING/DINING AREA
5.81m x 3.81m
19'1" x 12'6"

BEDROOM 1
4.88m x 3.08m
16'0" x 10'1"

BEDROOM 2
4.56m x 2.88m
15'0" x 9'6"

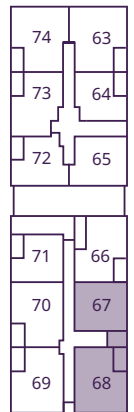

First Floor

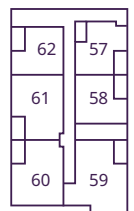
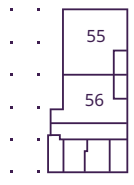

Ground Floor

Vickers House

Plot 71

1 BEDROOM HOME, 538 SQ.FT.



KITCHEN
3.69m x 1.87m
12'1" x 6'2"

LIVING/DINING AREA
3.83m x 3.81m
12'7" x 12'6"

BEDROOM 1
4.77m x 3.43m
15'8" x 11'3"

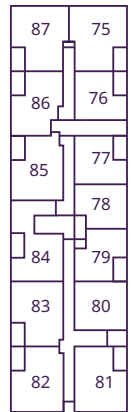

Second Floor

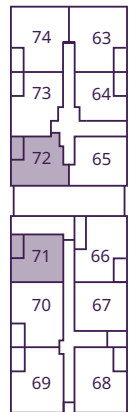

First Floor

Plot 72

1 BEDROOM HOME, 574 SQ.FT.



KITCHEN
2.98m x 2.48m
9'9" x 8'2"

LIVING/DINING AREA
5.20m x 4.14m
17'1" x 13'7"

BEDROOM 1
3.98m x 3.51m
13'1" x 11'6"

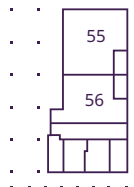

Ground Floor

Vickers House

Plot 73 & 86

2 BEDROOM HOME, 695 SQ.FT.



KITCHEN

3.72m x 1.88m
12'3" x 6'2"

LIVING/DINING AREA

4.07m x 3.83m
13'5" x 12'7"

BEDROOM 1

5.98m x 3.18m
19'8" x 10'5"

BEDROOM 2

2.84m x 2.75m
9'4" x 9'0"

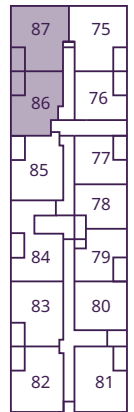

Second Floor

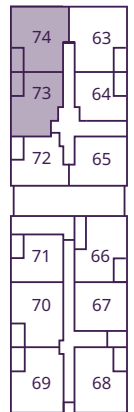

First Floor

Plot 74 & 87

2 BEDROOM HOME, 827 SQ.FT.



KITCHEN

3.29m x 3.14m
10'10" x 10'4"

LIVING/DINING AREA

5.81m x 3.76m
19'1" x 12'4"

BEDROOM 1

5.50m x 3.14m
18'1" x 10'4"

BEDROOM 2

4.38m x 2.83m
14'5" x 9'4"

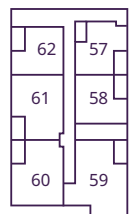
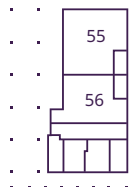

Ground Floor

Vickers House

Plot 77

1 BEDROOM HOME, 548 SQ.FT.



KITCHEN
3.75m x 1.89m
12'4" x 6'3"

LIVING/DINING AREA
3.94m x 3.82m
13'0" x 12'7"

BEDROOM 1
4.78m x 3.50m
15'8" x 11'6"

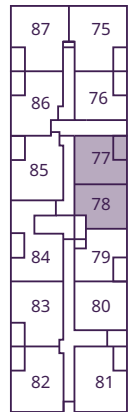

Second Floor

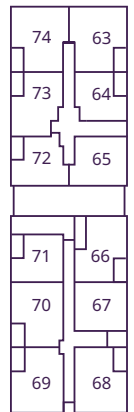

First Floor

Plot 78

1 BEDROOM HOME, 539 SQ.FT.



KITCHEN
3.06m x 1.87m
10'0" x 6'2"

LIVING/DINING AREA
5.99m x 3.50m
19'8" x 11'6"

BEDROOM 1
3.77m x 3.12m
12'4" x 10'3"

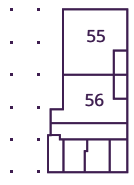

Ground Floor

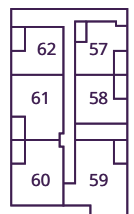

Vickers House

Plot 79

1 BEDROOM HOME, 544 SQ.FT.



KITCHEN/LIVING/ DINING AREA

5.81m x 4.11m
19'1" x 13'6"

BEDROOM 1

4.23m x 3.91m
13'11" x 12'10"

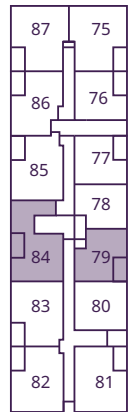

Second Floor

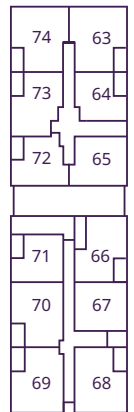

First Floor

Plot 84

2 BEDROOM HOME, 799 SQ.FT.



KITCHEN

3.69m x 2.37m
12'1" x 7'10"

LIVING AREA

4.00m x 3.33m
13'2" x 10'11"

DINING AREA

3.30m x 2.08m
10'10" x 6'10"

BEDROOM 1

4.52m x 2.97m
14'10" x 9'9"

BEDROOM 2

4.50m x 3.42m
14'10" x 11'3"

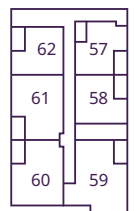
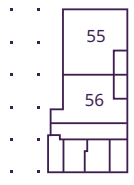

Ground Floor

Vickers House

Plot 85

2 BEDROOM HOME, 763 SQ.FT.



KITCHEN

3.14m x 2.47m
10'4" x 8'2"

LIVING/DINING AREA

5.81m x 3.85m
19'1" x 12'8"

BEDROOM 1

4.88m x 3.14m
16'0" x 10'4"

BEDROOM 2

4.56m x 3.09m
15'0" x 10'2"

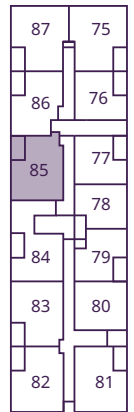

Second Floor

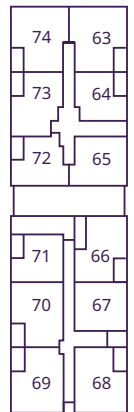

First Floor

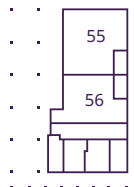

Ground Floor

Hawker House

A STUNNING COLLECTION OF
1 AND 2 BEDROOM APARTMENTS



Hawker House

Plot 1

3 BEDROOM HOME, 1,049 SQ.FT.



KITCHEN
3.08m x 2.40m
10'2" x 7'11"

LIVING/DINING AREA
5.43m x 3.08m
17'10" x 10'2"

BEDROOM 1
4.08m x 3.23m
13'5" x 10'8"

BEDROOM 2
4.51m x 2.88m
14'10" x 9'6"

BEDROOM 3
4.29m x 2.36m
14'1" x 7'9"

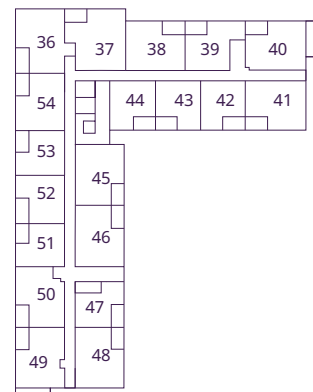

Second Floor

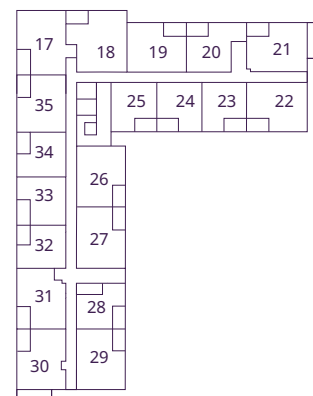

First Floor

Plot 2

2 BEDROOM HOME, 909 SQ.FT.



KITCHEN
3.53m x 2.85m
11'7" x 9'4"

LIVING/DINING AREA
5.39m x 4.99m
17'9" x 16'5"

BEDROOM 1
4.50m x 2.99m
14'9" x 9'10"

BEDROOM 2
4.54m x 3.08m
14'11" x 10'2"

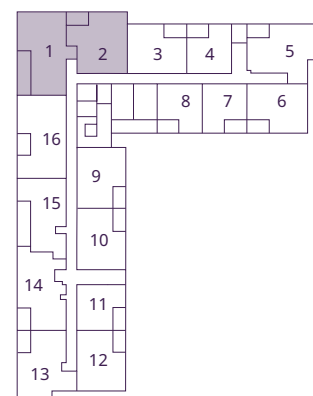

Ground Floor

The floorplans depict a typical layout of this housetype. For exact plot specification, details of external and internal finishes, dimensions and floorplan differences consult your sales executive. All dimensions are + or - 50mm and floorplans are not shown to scale. The kitchen layout and furniture positions are for indicative purposes only. Wardrobe positions and style are indicative only.

Hawker House

Plot 3

2 BEDROOM HOME, 770 SQ.FT.



KITCHEN
3.14m x 2.47m
10'4" x 8'2"

LIVING/DINING AREA
5.81m x 3.76m
19'1" x 12'4"

BEDROOM 1
4.88m x 3.14m
16'0" x 10'4"

BEDROOM 2
4.56m x 2.78m
15'0" x 9'2"

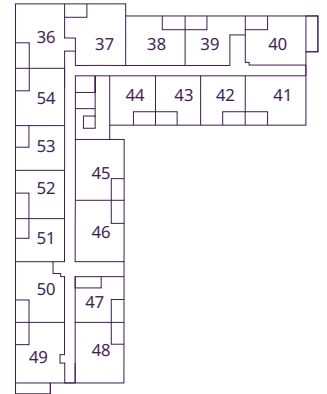

Second Floor

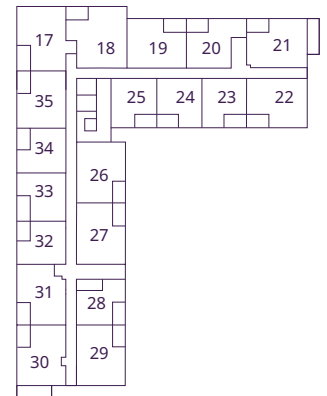

First Floor

Plot 4

1 BEDROOM HOME, 550 SQ.FT.



KITCHEN
3.81m x 1.87m
12'6" x 6'2"

LIVING/DINING AREA
3.96m x 3.83m
13'0" x 12'7"

BEDROOM 1
4.77m x 3.60m
15'8" x 11'10"

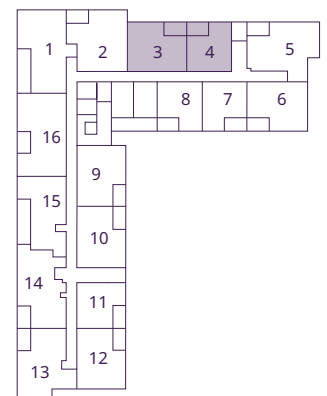

Ground Floor

Hawker House

Plot 5

3 BEDROOM HOME, 943 SQ.FT.



KITCHEN
4.30m x 3.08m
14'1" x 10'1"

LIVING/DINING AREA
5.81m x 3.76m
19'1" x 12'4"

BEDROOM 1
4.99m x 3.97m
16'5" x 13'1"

BEDROOM 2
4.56m x 2.88m
15'0" x 9'6"

BEDROOM 3
3.57m x 2.26m
11'9" x 7'5"

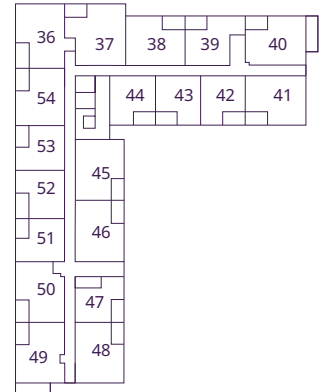

Second Floor

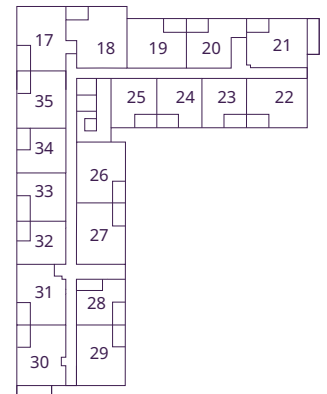

First Floor

Plots 6, 22 & 41

2 BEDROOM HOME, 774 SQ.FT.



KITCHEN
3.08m x 2.47m
10'1" x 8'2"

LIVING/DINING AREA
5.82m x 3.76m
19'1" x 12'5"

BEDROOM 1
4.88m x 3.08m
16'0" x 10'1"

BEDROOM 2
4.56m x 2.88m
15'0" x 9'6"

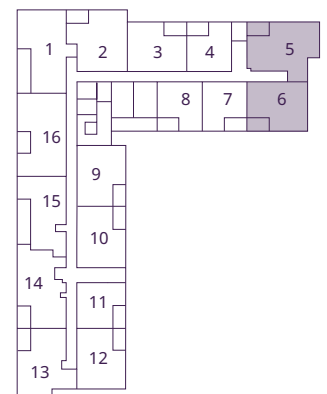

Ground Floor

The floorplans depict a typical layout of this housetype. For exact plot specification, details of external and internal finishes, dimensions and floorplan differences consult your sales executive. All dimensions are + or - 50mm and floorplans are not shown to scale. The kitchen layout and furniture positions are for indicative purposes only. Wardrobe positions and style are indicative only.

Hawker House

Plots 7, 23 & 42

1 BEDROOM HOME, 546 SQ.FT.



KITCHEN
3.75m x 1.87m
12'4" x 6'2"

LIVING/DINING AREA
3.90m x 3.85m
12'10" x 12'8"

BEDROOM 1
4.77m x 3.54m
15'8" x 11'8"

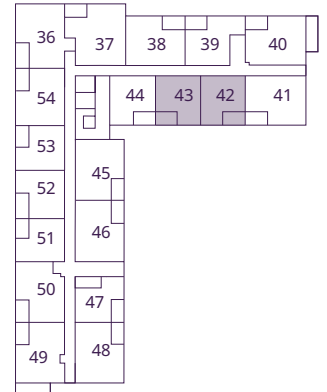

Second Floor

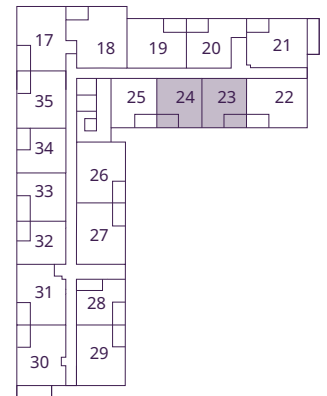

First Floor

Plots 8, 24 & 43

1 BEDROOM HOME, 546 SQ.FT.



KITCHEN
3.75m x 1.87m
12'4" x 6'2"

LIVING/DINING AREA
3.90m x 3.85m
12'10" x 12'8"

BEDROOM 1
4.77m x 3.54m
15'8" x 11'8"

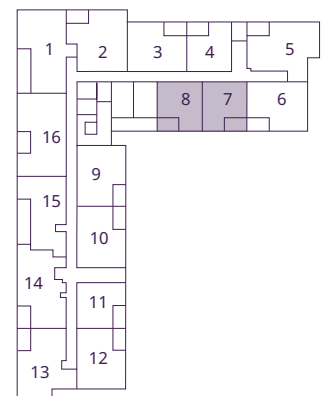

Ground Floor

Hawker House

Plots 9, 26 & 45

2 BEDROOM HOME, 773 SQ.FT.



KITCHEN
3.18m x 2.47m
10'5" x 8'2"

LIVING/DINING AREA
5.82m x 3.76m
19'1" x 12'4"

BEDROOM 1
4.88m x 3.18m
16'0" x 10'5"

BEDROOM 2
4.56m x 2.78m
15'0" x 9'2"

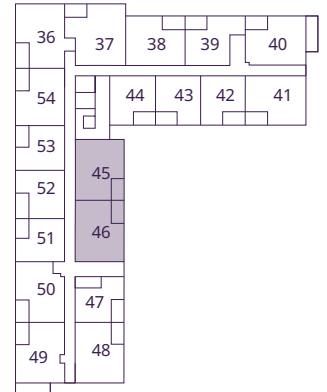

Second Floor

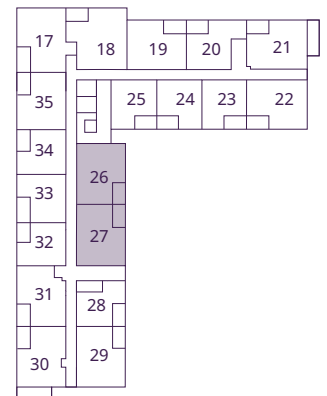

First Floor

Plots 10, 27 & 46

2 BEDROOM HOME, 776 SQ.FT.



KITCHEN
3.14m x 2.47m
10'4" x 8'2"

LIVING/DINING AREA
5.82m x 3.76m
19'1" x 12'4"

BEDROOM 1
4.88m x 3.14m
16'0" x 10'4"

BEDROOM 2
4.56m x 2.85m
15'0" x 9'5"

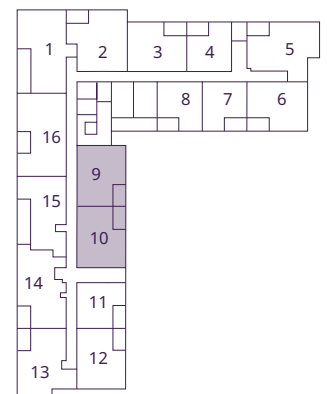

Ground Floor

Hawker House

Plot 11

1 BEDROOM HOME, 545 SQ.FT.



KITCHEN
3.75m x 1.89m
12'4" x 6'3"

LIVING/DINING AREA
3.90m x 3.81m
12'10" x 12'6"

BEDROOM 1
4.50m x 3.54m
14'10" x 11'8"

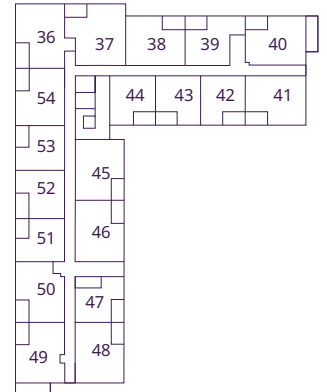

Second Floor

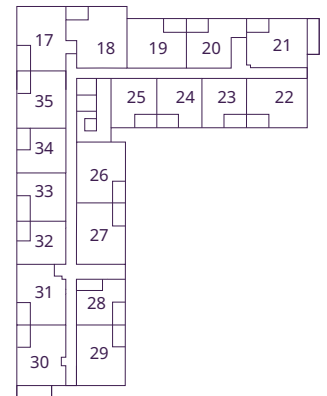

First Floor

Plot 12

2 BEDROOM HOME, 773 SQ.FT.



KITCHEN
3.08m x 2.47m
10'1" x 8'2"

LIVING/DINING AREA
5.82m x 3.76m
19'1" x 12'4"

BEDROOM 1
4.88m x 3.08m
16'0" x 10'1"

BEDROOM 2
4.56m x 2.88m
15'0" x 9'6"

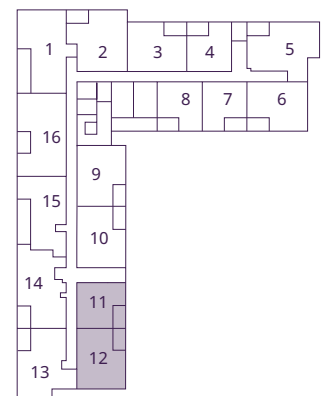

Ground Floor

Hawker House

Plot 13

3 BEDROOM HOME, 933 SQ.FT.



KITCHEN
3.76m x 1.89m
12'4" x 6'3"

LIVING/DINING AREA
5.59m x 3.81m
18'4" x 12'6"

BEDROOM 1
4.99m x 3.16m
16'5" x 10'5"

BEDROOM 2
4.30m x 3.08m
14'1" x 10'1"

BEDROOM 3
3.16m x 2.88m
10'5" x 9'6"

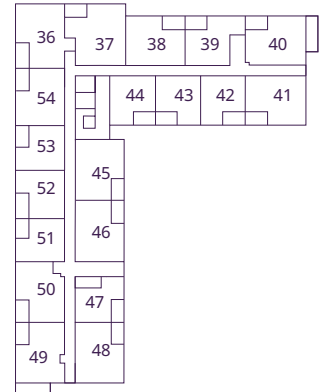

Second Floor

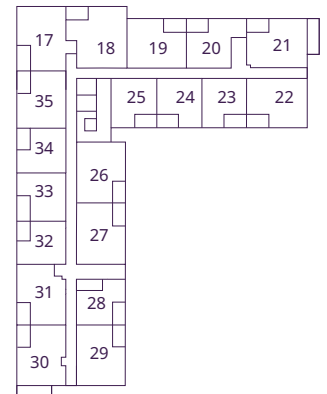

First Floor

Plot 14

3 BEDROOM HOME, 968 SQ.FT.



KITCHEN
4.25m x 1.89m
14'0" x 6'3"

LIVING/DINING AREA
4.25m x 3.81m
14'0" x 12'6"

BEDROOM 1
5.61m x 3.60m
18'5" x 11'10"

BEDROOM 2
3.76m x 3.55m
12'4" x 11'8"

BEDROOM 3
3.76m x 2.62m
12'4" x 8'7"

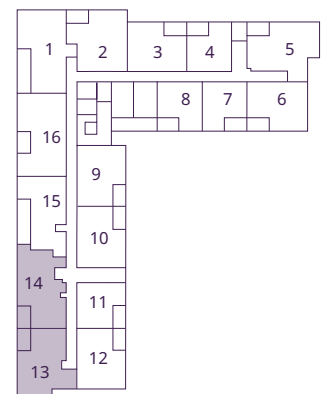

Ground Floor

The floorplans depict a typical layout of this housetype. For exact plot specification, details of external and internal finishes, dimensions and floorplan differences consult your sales executive. All dimensions are + or - 50mm and floorplans are not shown to scale. The kitchen layout and furniture positions are for indicative purposes only. Wardrobe positions and style are indicative only.

Hawker House

Plot 15

3 BEDROOM HOME, 871 SQ.FT.



KITCHEN
3.27m x 2.33m
10'9" x 7'8"

LIVING/DINING AREA
5.53m x 3.59m
18'2" x 11'10"

BEDROOM 1
5.81m x 2.75m
19'1" x 9'0"

BEDROOM 2
3.84m x 2.19m
12'7" x 7'2"

BEDROOM 3
4.01m x 1.99m
13'2" x 6'7"

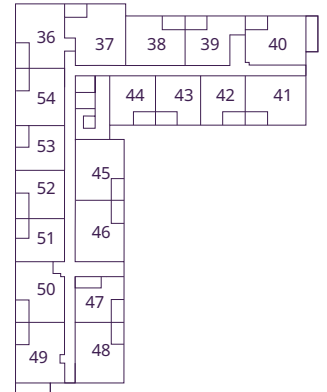

Second Floor

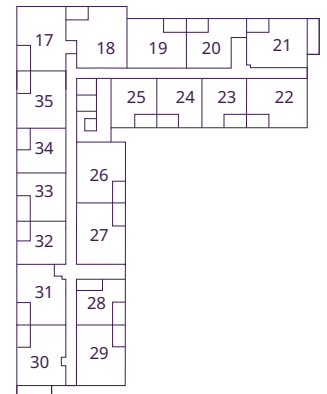

First Floor

Plot 16

3 BEDROOM HOME, 1,098 SQ.FT.



KITCHEN
4.66m x 1.90m
15'4" x 6'3"

LIVING/DINING AREA
5.96m x 3.35m
19'7" x 11'0"

BEDROOM 1
6.36m x 3.27m
20'11" x 10'9"

BEDROOM 2
4.14m x 2.80m
13'7" x 9'2"

BEDROOM 3
4.49m x 2.60m
14'9" x 8'7"

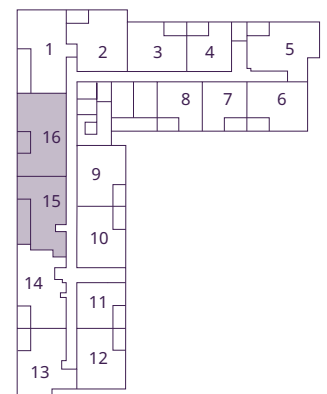

Ground Floor

The floorplans depict a typical layout of this housetype. For exact plot specification, details of external and internal finishes, dimensions and floorplan differences consult your sales executive. All dimensions are + or - 50mm and floorplans are not shown to scale. The kitchen layout and furniture positions are for indicative purposes only. Wardrobe positions and style are indicative only.

Hawker House

Plots 17 & 36

2 BEDROOM HOME, 805 SQ.FT.



KITCHEN
3.08m x 2.47m
10'2" x 8'2"

LIVING/DINING AREA
5.81m x 3.71m
19'1" x 12'2"

BEDROOM 1
3.63m x 3.08m
11'11" x 10'2"

BEDROOM 2
4.65m x 2.88m
15'3" x 9'6"

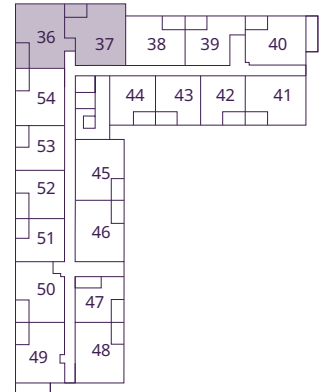

Second Floor

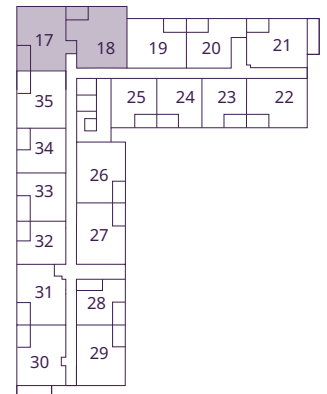

First Floor

Plots 18 & 37

2 BEDROOM HOME, 909 SQ.FT.



KITCHEN
3.53m x 2.85m
11'7" x 9'4"

LIVING/DINING AREA
5.39m x 4.99m
17'9" x 16'5"

BEDROOM 1
4.50m x 2.99m
14'9" x 9'10"

BEDROOM 2
4.54m x 3.08m
14'11" x 10'2"

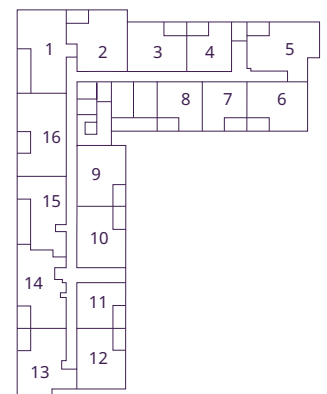

Ground Floor

The floorplans depict a typical layout of this housetype. For exact plot specification, details of external and internal finishes, dimensions and floorplan differences consult your sales executive. All dimensions are + or - 50mm and floorplans are not shown to scale. The kitchen layout and furniture positions are for indicative purposes only. Wardrobe positions and style are indicative only.

Hawker House

Plots 19 & 38

2 BEDROOM HOME, 770 SQ.FT.



KITCHEN
3.14m x 2.47m
10'4" x 8'2"

LIVING/DINING AREA
5.81m x 3.76m
19'1" x 12'4"

BEDROOM 1
4.88m x 3.14m
16'0" x 10'4"

BEDROOM 2
4.56m x 2.78m
15'0" x 9'2"

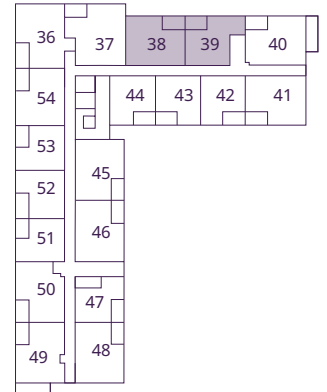

Second Floor

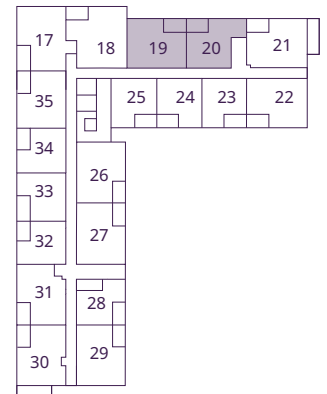

First Floor

Plots 20 & 39

1 BEDROOM HOME, 628 SQ.FT.



KITCHEN/LIVING/DINING AREA
5.81m x 4.24m
19'1" x 13'11"

BEDROOM 1
4.83m x 3.60m
15'10" x 11'10"

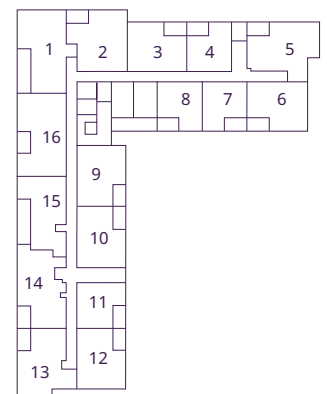

Ground Floor

The floorplans depict a typical layout of this housetype. For exact plot specification, details of external and internal finishes, dimensions and floorplan differences consult your sales executive. All dimensions are + or - 50mm and floorplans are not shown to scale. The kitchen layout and furniture positions are for indicative purposes only. Wardrobe positions and style are indicative only.

Hawker House

Plots 21 & 40

2 BEDROOM HOME, 770 SQ.FT.



KITCHEN
3.08m x 2.47m
10'1" x 8'2"

LIVING/DINING AREA
5.82m x 3.76m
19'1" x 12'4"

BEDROOM 1
3.64m x 3.08m
11'11" x 10'1"

BEDROOM 2
4.56m x 2.88m
15'0" x 9'6"

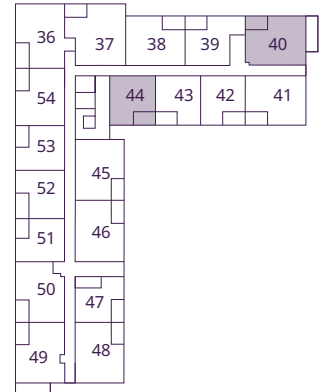

Second Floor

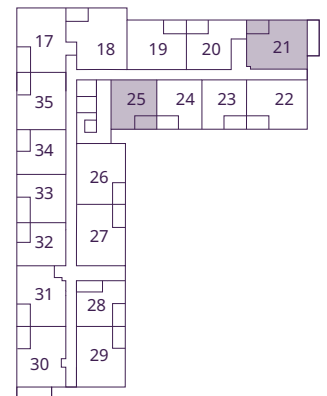

First Floor

Plots 25 & 44

1 BEDROOM HOME, 559 SQ.FT.



KITCHEN
3.90m x 1.87m
12'10" x 6'2"

LIVING/DINING AREA
4.05m x 3.85m
13'4" x 12'8"

BEDROOM 1
4.50m x 3.40m
14'9" x 11'2"

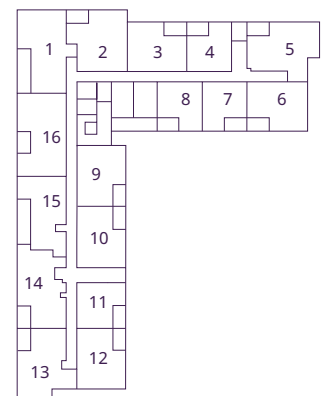

Ground Floor

The floorplans depict a typical layout of this housetype. For exact plot specification, details of external and internal finishes, dimensions and floorplan differences consult your sales executive. All dimensions are + or - 50mm and floorplans are not shown to scale. The kitchen layout and furniture positions are for indicative purposes only. Wardrobe positions and style are indicative only.

Hawker House

Plots 28 & 47

1 BEDROOM HOME, 621 SQ.FT.



**KITCHEN/LIVING/
DINING AREA**
5.81m x 4.30m
19'1" x 14'2"

BEDROOM 1
4.83m x 3.00m
15'10" x 9'10"

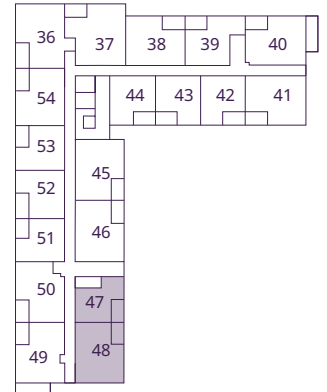

Second Floor

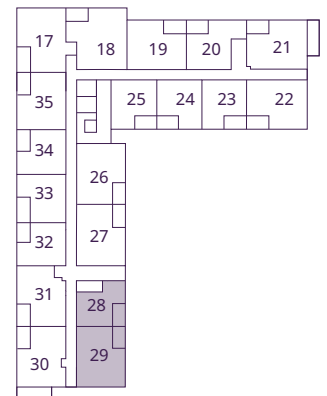

First Floor

Plots 29 & 48

2 BEDROOM HOME, 773 SQ.FT.



KITCHEN
3.08m x 2.47m
10'1" x 8'2"

LIVING/DINING AREA
5.82m x 3.76m
19'1" x 12'4"

BEDROOM 1
4.88m x 3.08m
16'0" x 10'1"

BEDROOM 2
4.56m x 2.88m
15'0" x 9'6"

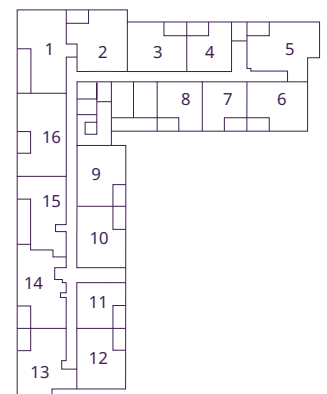

Ground Floor

Hawker House

Plots 30 & 49

2 BEDROOM HOME, 760 SQ.FT.



KITCHEN
3.08m x 2.47m
10'2" x 8'2"

LIVING/DINING AREA
5.82m x 3.36m
19'1" x 11'1"

BEDROOM 1
3.64m x 3.08m
12'0" x 10'1"

BEDROOM 2
3.90m x 3.28m
12'10" x 10'10"

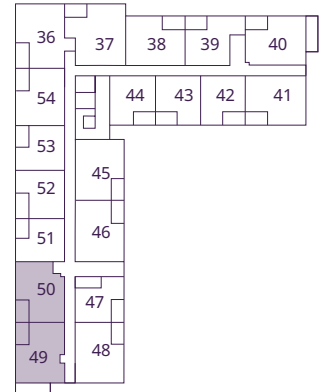

Second Floor

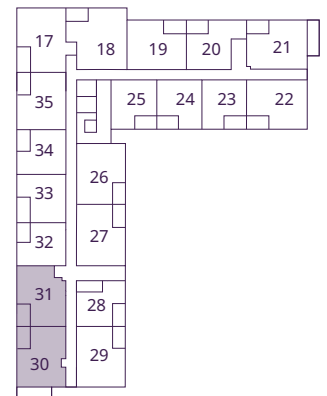

First Floor

Plots 31 & 50

2 BEDROOM HOME, 724 SQ.FT.



KITCHEN
4.25m x 1.89m
14'0" x 6'3"

LIVING/DINING AREA
4.25m x 3.81m
14'0" x 12'6"

BEDROOM 1
4.96m x 2.75m
16'4" x 9'0"

BEDROOM 2
3.31m x 2.75m
10'10" x 9'0"

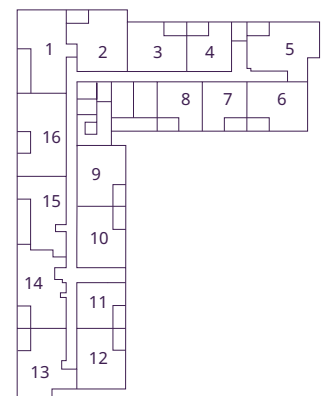

Ground Floor

Hawker House

Plots 32 & 51

1 BEDROOM HOME, 551 SQ.FT.



KITCHEN
3.86m x 1.89m
12'8" x 6'3"

LIVING/DINING AREA
3.98m x 3.81m
13'1" x 12'6"

BEDROOM 1
4.77m x 3.61m
15'8" x 11'10"

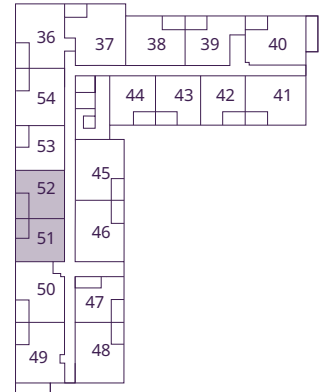

Second Floor

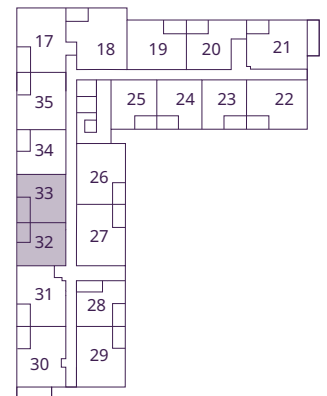

First Floor

Plots 33 & 52

1 BEDROOM HOME, 549 SQ.FT.



KITCHEN
3.81m x 1.89m
12'6" x 6'3"

LIVING/DINING AREA
3.93m x 3.82m
12'11" x 12'6"

BEDROOM 1
4.77m x 3.59m
15'8" x 11'10"

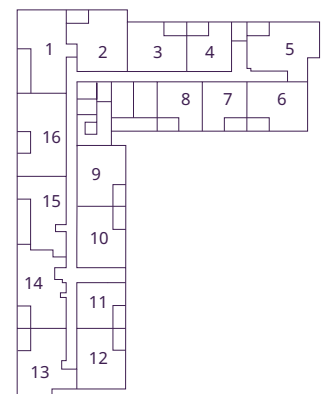

Ground Floor

Hawker House

Plots 34 & 53

1 BEDROOM HOME, 544 SQ.FT.



KITCHEN
3.67m x 1.89m
12'1" x 6'3"

LIVING/DINING AREA
3.81m x 3.81m
12'6" x 12'6"

BEDROOM 1
4.77m x 3.49m
15'8" x 11'6"

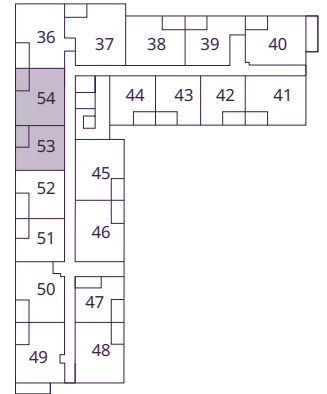

Second Floor

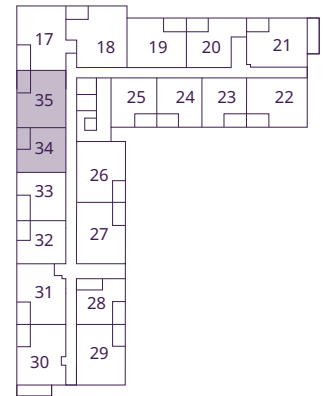

First Floor

Plots 35 & 54

2 BEDROOM HOME, 773 SQ.FT.



KITCHEN
3.17m x 2.47m
10'5" x 8'2"

LIVING/DINING AREA
5.81m x 3.81m
19'1" x 12'6"

BEDROOM 1
4.88m x 3.17m
16'0" x 10'5"

BEDROOM 2
4.56m x 2.78m
15'0" x 9'2"

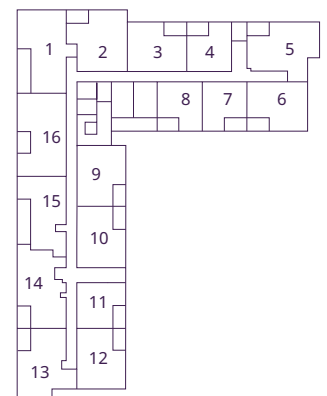

Ground Floor

The floorplans depict a typical layout of this housetype. For exact plot specification, details of external and internal finishes, dimensions and floorplan differences consult your sales executive. All dimensions are + or - 50mm and floorplans are not shown to scale. The kitchen layout and furniture positions are for indicative purposes only. Wardrobe positions and style are indicative only.

High-quality homes

At Taylor Wimpey we build high-quality homes with modern interior designs. Each home can be personalised to your taste even before you move in.

GENERAL

Double glazed uPVC windows with multi-point locking	✓
White emulsion to walls	✓
White switches and sockets throughout	✓
White internal doors with chrome door furniture	✓
NHBC warranty against structural defects for a 10-year period and 2-year Taylor Wimpey warranty	✓
Video door entry system	✓
Carbon monoxide and smoke detectors	✓
Sensations carpet in bedroom/s and living room	✓
Amtico Spacia flooring in all other rooms	✓
Deta TV/DAB/FM point (Sky Q compatible)	✓
Downlighters to wet rooms	✓

KITCHEN

Symphony kitchen	✓
Zanussi oven	✓
Zanussi appliances (fridge/freezer, washer/dryer, dishwasher)	✓
Zanussi 4 burner gas hob	✓
Stainless steel splashback behind hob	✓



BATHROOMS, EN SUITES & CLOAKROOM

White Roca bathroom suite	✓
Ideal chrome taps	✓
Bathroom – Porcelanosa half-height tiling to bath and half-height tiling behind sanitaryware wall/s (where there is an en suite)	✓
Bathroom – Porcelanosa full-height tiling around bath, half-height behind sanitaryware wall/s (where there is no en suite)	✓
Bathroom – bath screen and thermostatic shower (where there is no en suite)	✓
En suite – Porcelanosa full-height tiling to shower enclosure and half-height tiling behind sanitaryware wall/s and thermostatic shower	✓
Cloakroom – Porcelanosa splashback tiling above sink	✓

OPTIONAL UPGRADES (SUBJECT TO BUILD STAGE)

Stone worktop	✓
Chrome sockets and switches	✓
Towel rails in en suite and bathroom*	✓
Additional wall tiling	✓
Amtico Spacia to living room	✓
Shower over bath and screen	✓

Standard specifications are correct at time of going to print, but are subject to change without notice. The options available and are subject to stage of construction. We will not be able to accommodate any changes to the specification or layout other than the options available. Options are correct at time of going to print, but are subject to plot size. Please contact the sales executive for further information. *Plot specific.

Why buy new?

1 NO BUYING CHAIN

No buying chain means less stress and hassle.



2 SAVE MONEY ON BILLS

Save money on your household bills from Day 1.

3 BLANK CANVAS

Start with a blank canvas and create your home your way.



4 COMMUNITY

Become part of a new and growing community.

5 PEACE OF MIND

Enjoy real peace of mind with our two-year warranty.

Ways to move

Everyone knows buying a new home is an exciting time. But it can be a stressful one too, which is why our sales executives and customer relations managers are there to help every step of the way, from your initial enquiry right through to opening the front door of your new home for the first time.

HERE TO HELP
YOU BUY



The Armed forces discount is exclusively available to armed forces personnel.

HERE TO HELP
YOU SELL



EASYMOVER

easymover could help remove some of the stress if you need to sell your existing house.



Taylor Wimpey are a 5-star builder and would be recommended by over 90% of our customers

To find out more, just give us a call, pop in for a chat, or pay us a visit at taylorwimpey.co.uk and view our handy Homebuyer Guides.

How to buy a new home

1 START YOUR RESEARCH ONLINE

Start with a search for a new home in the area you want to live in, then take a look at our virtual tours to see inside our homes.



2 GET IN TOUCH

Get in touch with one of our helpful sales executives. They are ready and waiting to take your call and help you find the home of your dreams.



3 WE'VE GOT LOTS OF WAYS TO HELP YOU BUY

Whether you're a first time buyer or you already own a home, we can make moving home easy.

4 RESERVING YOUR NEW HOME

If you've found the home of your dreams and you are confident that you can afford to buy it, then it's time to reserve it.

5 PERSONALISE YOUR HOME

Choose from our fabulous range of kitchen, bathroom and flooring options and make your new home your own.





LANCASTER SQUARE

SOUTH RUISLIP

LANCASTER SQUARE
Bourne Court – South Ruislip – HA4 6SW

CONTACT US
01895 807 641



Taylor Wimpey reserves the right to change specifications, designs, floorplans and siteplans at any time. All lifestyle and location imagery used within this brochure is indicative only. Please ask the sales executive for up-to-date information when reserving your new home. Information is correct at the time of going to print. Please see the development page on our website for further details. Distances and times are taken from, [google.co.uk/maps](https://www.google.co.uk/maps), [nationalrail.co.uk](https://www.nationalrail.co.uk) and [tfl.gov.uk](https://www.tfl.gov.uk), and are approximate only. Taylor Wimpey houses are sold freehold and apartments are sold leasehold. For terms and conditions on our schemes and incentives including easymover and armed forces discount, go to www.taylorwimpey.co.uk/terms. Information is correct at the time of going to print. Please speak to your sales executive for further details. October 2022.